

## M7N, AKA M74 Mechanical Seal for Chemical Pumps, KSB/Kaiquan Water Pumps and Double Suction Pumps M7N (M74)型机械密封

**Structural Features:** single end, wave spring (M7N), multi springs (M74), unbalanced, independent direction of rotation, lug transmission. M7N has a simple way of transmission and good compatibility; the wave spring structure allows transferring particulate, crystallized and high viscosity content. M74 also has a simple way of transmission and the compensation components are pre-assembled; it is easy to install and has good compensation. The load on the seal faces are balanced and the sealing performance is stable and reliable.

**结构特点:** 单端面, 波形弹簧 (M7N), 多弹簧 (M74), 非平衡型, 任意旋向, 耳传动。传动方式简单可靠, 互换性好; 波形弹簧结构 (M7N) 允许输送含颗粒、结晶、粘度大的物料, 应用广泛。多弹簧布置 (M74), 端面负荷均匀, 安装简单, 调整方便, 密封性能稳定可靠。

**Standards:** ISO3069, GB6556, DIN24960  
**符合标准:** ISO3069, GB6556, DIN24960

**Scopes of Application:** widely used in chemical processing, oil refining, petrochemical engineering, sewage treatment, pharmacy and food production. Designed for chemical pumps, water pumps, screw pumps, sewage pumps, double suction pumps, paper making equipment and other rotary devices.

**应用领域:** 广泛应用于化工流程、炼油、石化、污水处理、造纸、制药和食品加工等领域。  
可同化工泵、清水泵、螺杆泵、污水泵、双吸泵和造纸设备等其他旋转设备配套。

**Inner Diameter:** 20 mm to 300 mm  
**规格范围:** 20 mm - 300 mm

### Materials

Rotary Ring Face: SiC/TC  
Stationary Ring Face: Carbon/SiC/TC  
Elastomers: NBR/EPDM/Viton/FFKM  
Springs: SS304/SS316/PH17-4/HC-276  
Metal Parts: 410S/SS304/SS316/SS316L/Hastelloy

### 材料

旋转环端面: 碳化硅/碳化钨  
静止环端面: 石墨/碳化硅/碳化钨  
辅助密封: 丁腈橡胶/三元乙丙橡胶/氟橡胶/全氟醚橡胶  
弹簧: SS304/SS316/PH17-4/HC-276  
金属部件: 410S/SS304/SS316/SS316L/哈氏合金

### Operation Parameters

Pressure:  $\leq 1.6$  MPa  
Temperature:  $-40 \sim 200$  °C  
Linear Speed:  $\leq 20$  m/s  
运行参数  
压力:  $\leq 1.6$  MPa  
温度:  $-40 \sim 200$  °C  
线速度:  $\leq 20$  m/s

**Mediums:** oil, water, acid, alkali, organic solvents and subjects that are easy to be crystallized or have granules and high viscosity.

**适用介质:** 水、油、酸、碱、有机溶剂等, 允许含少量颗粒、结晶、粘度大的介质。

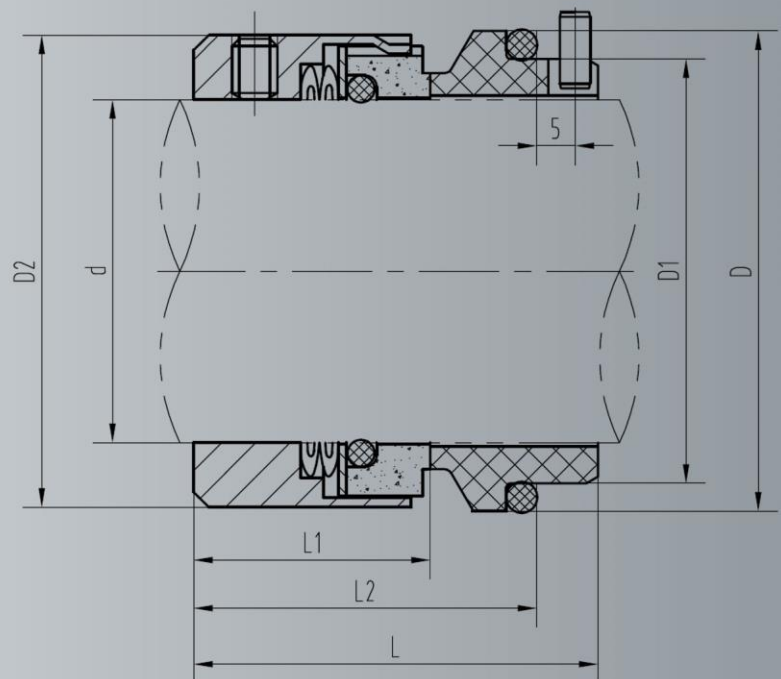

## M7N (M74) Mechanical Seal Dimension Chart - M7N (M74)型机械密封尺寸对照表

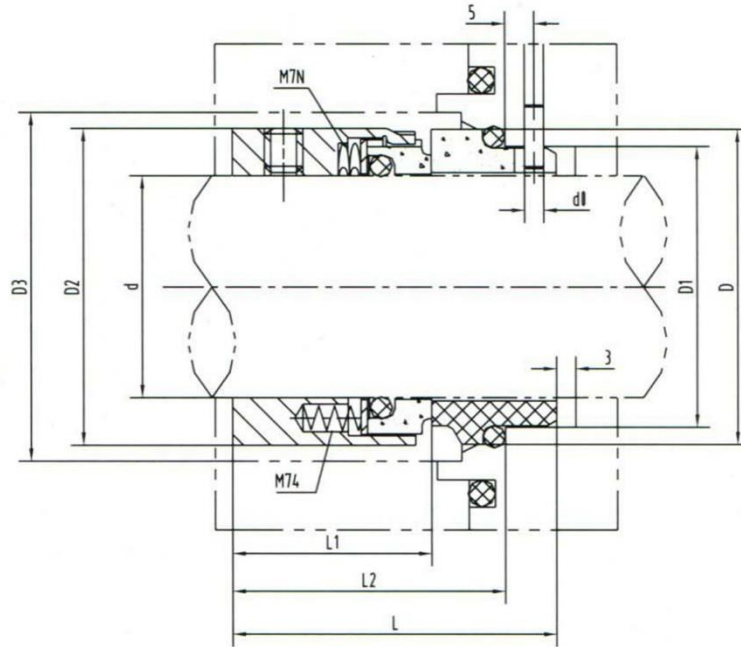

Dimensions	d	D	D1	D2	D3	L	L1	L2	d0
Shaft Sizes	h6	H8	H11						
18	18	33.0	27.0	33	37	45.5	26.0	37.5	3
20	20	35.0	29.0	35	39	45.5	26.0	37.5	3
22	22	37.0	31.0	37	41	45.5	26.0	37.5	3
24	24	39.0	33.0	39	43	48.0	28.5	40.0	3
25	25	40.0	34.0	40	45	48.0	28.5	40.0	3
28	28	43.0	37.0	43	47	50.5	31.0	42.5	3
30	30	45.0	39.0	45	49	50.5	31.0	42.5	3
33	33	48.0	42.0	48	51	50.5	31.0	42.5	3
35	35	50.0	44.0	50	54	50.5	31.0	42.5	3
38	38	56.0	49.0	55	59	53.0	31.0	45.0	4
40	40	58.0	51.0	57	61	53.0	31.0	45.0	4
43	43	61.0	54.0	60	65	53.0	31.0	45.0	4
45	45	63.0	56.0	62	66	53.0	31.0	45.0	4
48	48	66.0	59.0	65	69	53.0	31.0	45.0	4
-50	50	70.0	62.0	67	71	55.5	32.5	47.5	4
53	53	73.0	65.0	70	75	55.5	32.5	47.5	4
55	55	75.0	67.0	72	76	55.5	32.5	47.5	4
58	58	78.0	70.0	79	83	60.5	37.5	52.5	4
60	60	80.0	72.0	81	85	60.5	37.5	52.5	4
65	65	85.0	77.0	86	95	60.5	37.5	52.5	4
70	70	92.0	83.0	91	95	68.0	42.0	60.0	4
75	75	97.0	88.0	99	105	68.0	42.0	60.0	4
80	80	105.0	95.0	104	109	68.0	41.8	60.0	4
85	85	110.0	100.0	109	114	68.0	41.8	60.0	4
90	90	115.0	105.0	114	119	73.0	46.8	65.0	4
95	95	120.0	110.0	119	124	73.0	47.8	65.0	4
100	100	125.0	115.0	124	129	73.0	47.8	65.0	4
105	105	134.3	122.2	138	144	77.0	47.0	67.0	5
110	110	140.3	128.2	143	149	77.0	47.0	67.0	5
115	115	148.3	136.2	148	154	77.0	47.0	67.0	5
120	120	150.3	138.2	153	159	77.0	47.0	67.0	5
125	125	154.3	142.2	158	164	77.0	47.0	67.0	5
130	130	158.3	146.2	163	169	77.0	47.0	67.0	5
135	135	164.3	152.2	168	174	77.0	47.0	67.0	5
140	140	168.3	156.2	173	181	77.0	47.0	67.0	5
145	145	173.3	161.2	178	186	77.0	47.0	67.0	5
150	150	180.3	168.2	183	191	79.0	47.0	69.0	5
155	155	185.3	173.2	191	199	90.0	56.0	80.0	5
160	160	190.3	178.2	196	204	90.0	56.0	80.0	5
165	165	195.3	183.2	201	209	90.0	56.0	80.0	5
170	170	200.3	188.2	206	214	90.0	56.0	80.0	5
175	175	205.3	193.2	211	219	90.0	56.0	80.0	5
180	180	219.3	207.5	216	224	94.0	56.0	84.0	5
185	185	224.3	212.5	221	229	94.0	56.0	84.0	5
190	190	229.3	217.5	226	234	94.0	56.0	84.0	5
195	195	234.3	222.5	231	239	94.0	56.0	84.0	5
200	200	239.3	227.5	236	244	94.0	56.0	84.0	5